

For bidding purposes only, not a design doc. LTUSD 04/15/19
 Contractor must field verify available space and location of support column.

Specifications

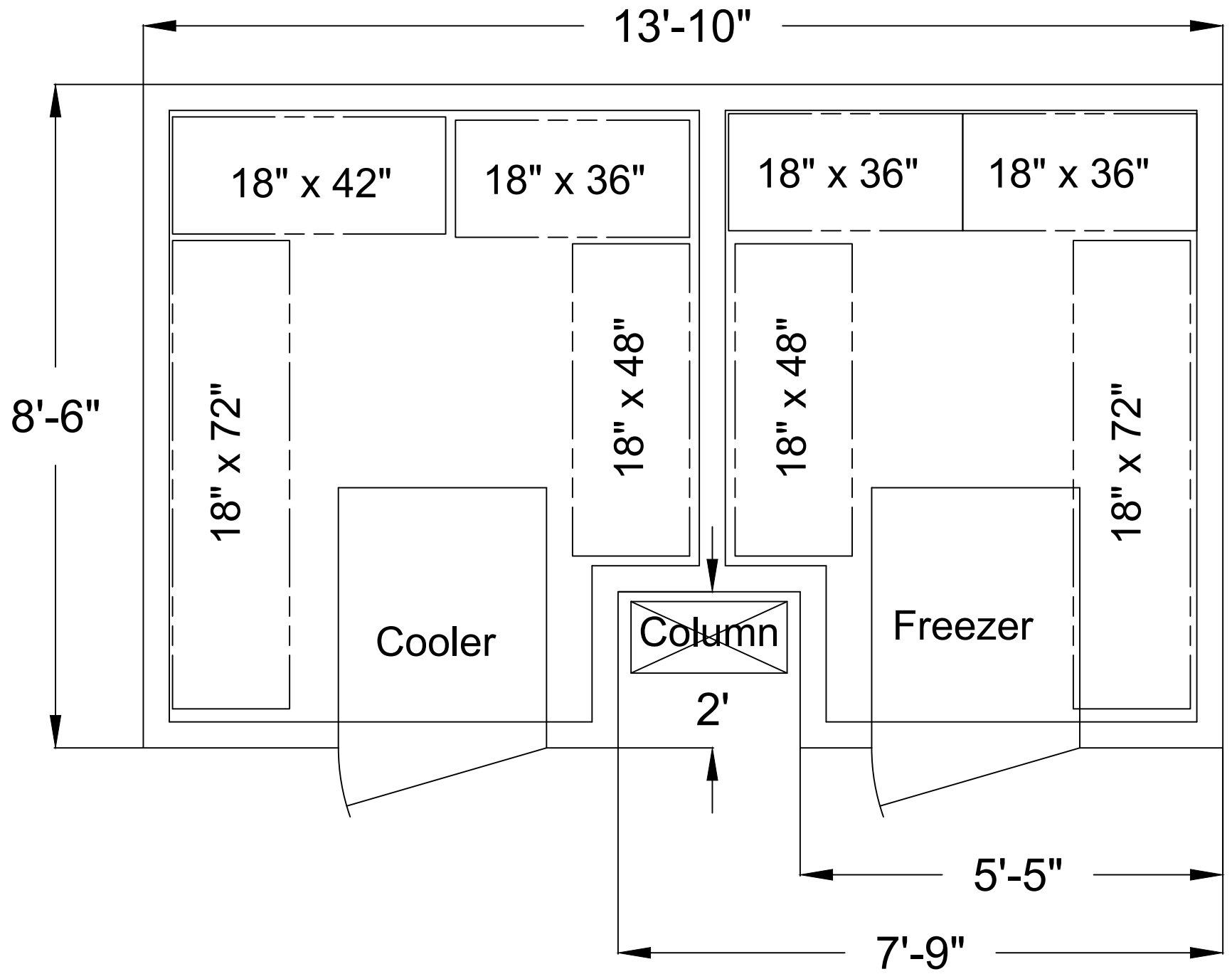

Plan View



Front View (exterior)

Construction:

Freezer:

- Wall: 4" Foam-frame, polyurethane, F-I-P
- Ceiling: 4" Foam-frame, polyurethane, F-I-P
- Floor: 4" Wood-frame, polyurethane, F-I-P
 One (1) layer of 3/4 " plywood (built-in) on top

Cooler:

- Wall: 4" Foam-frame, polyurethane, F-I-P
- Ceiling: 4" Foam-frame, polyurethane, F-I-P
- Floor: 4" Wood-frame, polyurethane, F-I-P
 One (1) layer of 3/4 " plywood (built-in) on top

Refrigerant: R448-A

Finish:

- Wall: 26GA, Stucco-Galvalum Interior
 26GA, Stucco-Galvalum Exterior
- Ceiling: 26GA, Stucco-Galvalum Interior
 26GA, Stucco-Galvalum Exterior
- Floor: 0.050" Smooth Alum. Interior W/Non Skid Strip
 26GA, Stucco-Galv. Exterior

Accessories:

- 1 EA. – 36" x 80" Hinged Overlap Freezer Door
 Self Closing
 Heated Frame, Belly and Sweep
 14" x 14" port window
- 1 EA. – 36" x 80" Hinged Overlap Cooler Door,
 Self Closing
 14" x 14" port window
- 2 EA. – Kason 1808 LED Light Fixture
- 2 EA. – Light Switch W/Digital Tm.
- 1 EA. – Heated Air Vent #1825
- 4 EA. – 18" deep epoxy wire shelving set

Note: Cam Lock Ceiling

Cam Lock Floor

The Ceiling is designed for "No Storage"